

THIS DRAWING IS AN UNCONTROLLED COPY UNLESS STAMPED OTHERWISE

CONTRACTORS SHALL VERIFY DIMENSIONS BEFORE ANY JOB COMMENCES. ALL SHOP DRAWINGS SHALL BE SUBMITTED TO THE SUPERINTENDENT AND MANUFACTURER SHALL NOT COMMENCE FROM TO THE RETURN OF DIMENSIONS SHOP DRAWINGS ISSUED BY THE CONSULTANT. DIMENSIONS SHALL TAKE PRECEDENCE OVER SCALES. THIS DRAWING SHALL BE USED IN CONSTRUCTION WITH ALL RELEVANT CONTRACT SPECIFICATIONS AND DRAWINGS COPYRIGHT OF THIS DRAWING IS VESTED IN HANDLE

General Notes

REFER ARCHITECTURAL DRAWINGS:

FACADE SETOUT AR1502-AR1507
 PRECAST SETOUT AR1512-AR1517
 SCREEN SETOUT AR1502-AR1557
 SCREEN DETAILS AR6500-AR6554

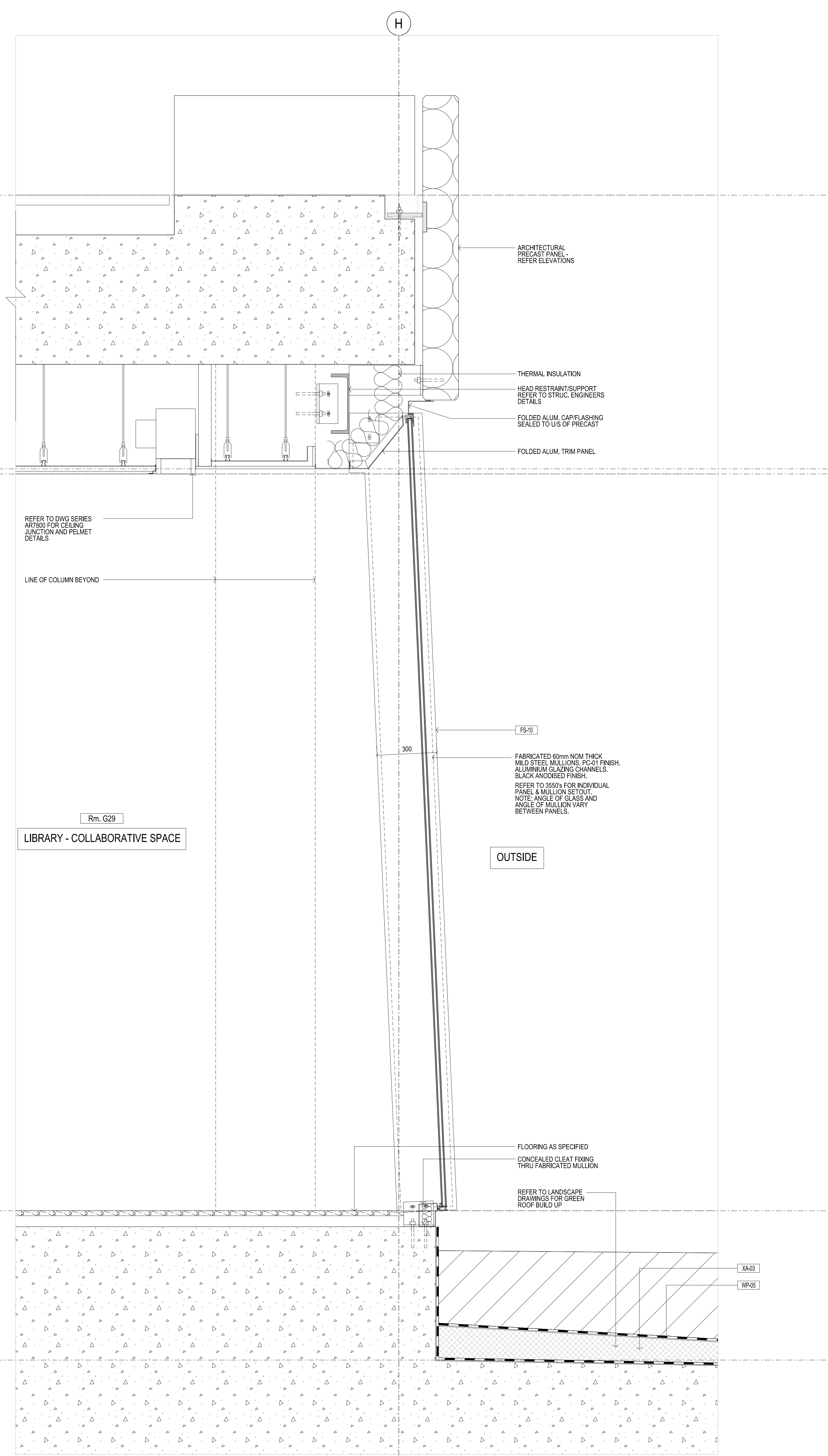

01 SECTION DETAIL
 1502 SCALE 1:10

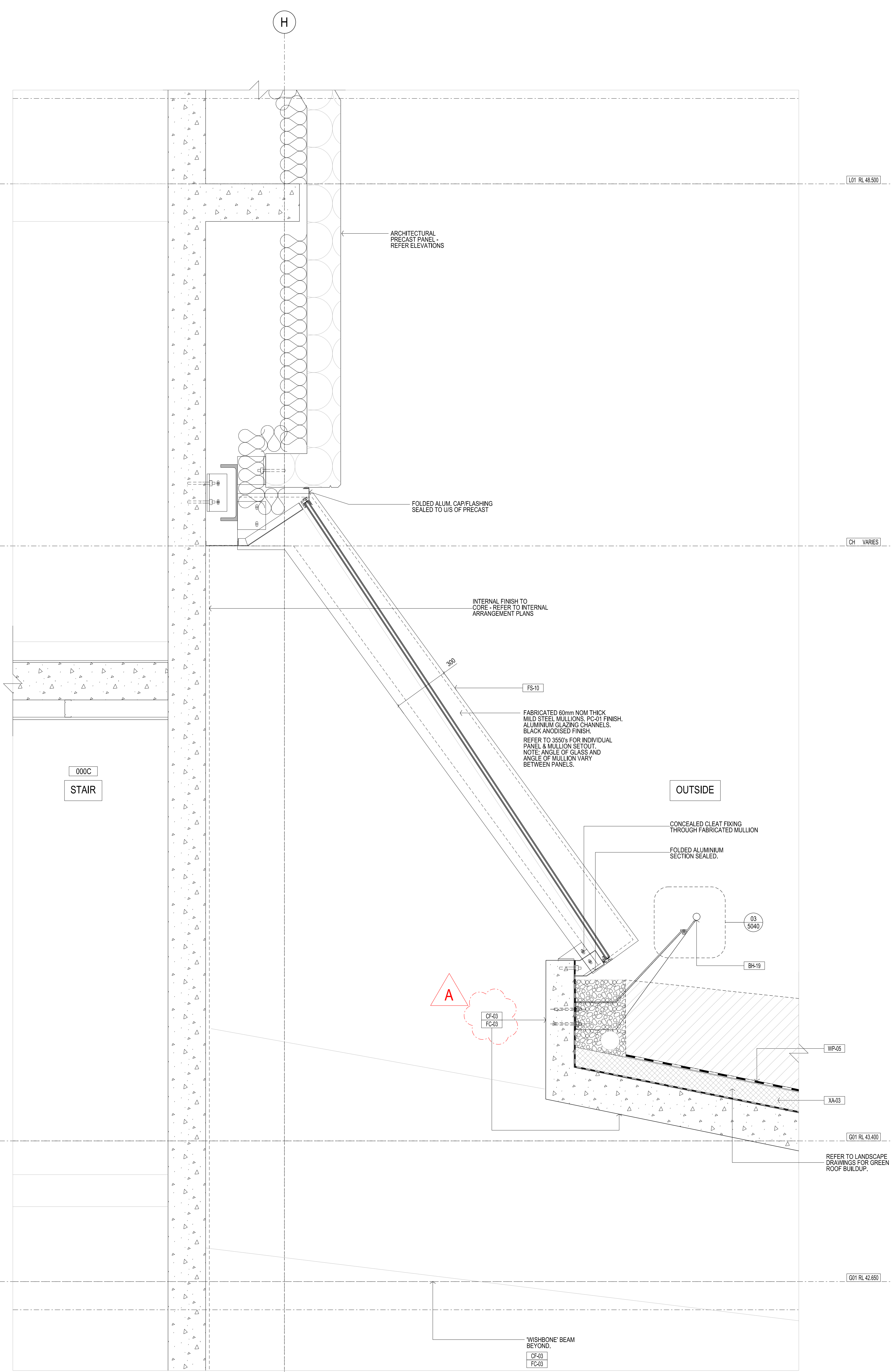

02 SECTION DETAIL
 3505 SCALE 1:10

Rev	Issue	Revision Description	And	Date
A	SG	ISSUE FOR CONSTRUCTION	-	10.10.13
09	SG	TENDER ISSUE	-	12.04.13
08	SG	VALUE MANAGEMENT ISSUE	-	28.03.13
07	SG	PRECAST REVIEW	-	21.03.13
06	SG	100% CD - TENDER ISSUE	-	07.05.12
05	SG	50% CD ISSUE	-	08.06.12
04	JC	FINAL DD ISSUE	-	24.02.12
03	JC	DESIGN DEVELOPMENT ISSUE	-	20.01.12
02	JC	DESIGN DEVELOPMENT ISSUE	-	22.12.11
01	JC	PRELIMINARY DD	-	28.10.11



NADAAA
 NADAAA
 1520 Washington Street No.2 Boston Massachusetts 02118 USA
 Telephone +1 817 442 8232 Facsimile +1 888 442 1417 Email nad@nadaaa.com

John Wardle Architects
 25 Rokeby Street, Collingwood, Victoria 3066 Australia
 Tel: +61 3 8662 0400 www.johnwardlearchitects.com
 © 2012 John Wardle Architects ABN 83 006 814 268

Client **University of Melbourne Parkville Campus**

Project **Faculty of Architecture Building and Planning**

Title **SECTION DETAILS SHEET 7**

Project No. **0913** Scale 1:10 @ A0
 Drawing No. **AR6106** Revision **A**
 Date Dec 2011 Dwn - Co-Ord - Chk -

FILENAME - \$FILES
FOR CONSTRUCTION